



The Craft Complex for the Rehabilitation of Displace Woman

Fardous Alhaj, Tassneem Ejail and Tanzeil Ibrahim

EasyChair preprints are intended for rapid dissemination of research results and are integrated with the rest of EasyChair.

January 11, 2022

Project Name:-

The Craft Complex For Rehabilitation Of Displace Woman

(Sudan – Darfur state)

Authors :-

- 1- Fardous abdalrasoul adam .
- 2- Tassneem Musa Elamin .
- 3- Tanzeil osman abdelmoula Ibrahim.

Project Abstract:

Praise be to God, a great thank you that we seek help from, and prayers and peace be upon our Prophet Muhammad, may God's prayers and peace be upon him. Oh God, open up my chest for me, show me my affair, and loosen the knot from my tongue, so that he understands it.

Rural development, consideration and concern for post-war regions and people by providing appropriate conditions for the exercise of his life and activities in a normal and sound manner is an indispensable means for achieving national goals in developmental development and human justice in its social, educational, cultural, economic and health aspects that work to promote the life of the individual and society. Attributing to the harsh conditions that the displaced woman in Darfur went through, which forced her to engage in arduous work such as making bricks, building shelters and working as a construction assistant ... etc., to earn a living and feed her children, we had to provide the deserved earning, living and education opportunities that she was deprived of. Because of the importance of the role of women in society, it is necessary to refine their capabilities through education to educate them to lead a healthy life and play their role in building society while practicing possible leisure activities. Increasing educational, cultural and entertaining awareness among women, and highlighting the importance of handicrafts in the region, which plays an important role in local industry sector

This project presents an architectural project aims to rehabilitate human beings in post-war areas. It is intended for women. . . Includes basic levels of education (The literacy) and to increase their productivity; through pursuing training processes are conducted on teach handicrafts, and a mine for skills development, housing for women from outside the state, Providing her needs form cultural, social, recreational and sports activities And services that include care and psychological counseling, and a section for the care of their children, with a special department for the affairs of the displaced, a public administration and public services.

Introduction :

The craft complex for the rehabilitation is a artisan a rehabilitation Cultural ,Social, Residential development center . Includes basic levels of education (The literacy) and to increase their productivity; through pursuing training processes are conducted on craft work and skills development . providing job opportunities in the craft field such as (sewing, making traditional products (Albrtal) - textile - gardening - the fin works – etc) inside the center and further acts as a community center for the neighborhood . And the provision of internal housing for women who wish within the complex with the provision of educational opportunities, the practice of social, cultural and psychological health activities, the rehabilitation of the residents of the area , the practice of follow-up operations, training, administrative supervision and the general services that accompany the center. The complex collecting displaced women, rural women in the region, the external trainees and literacy students and professional trainers, teachers, rehabilitation and psychological health specialists.

Related study :

Case study:

1- International

Women's Opportunity Center

- **Components for a project** : Housing for students and trainers - classrooms - a place to care for poultry - administrative offices - housing for the director and a house to welcome guests - a commercial center and kitchen - a social gathering area.
- Designed to help women affected by the wars in Rwanda.

Location : Africa – Kuzona – Rwanda .

- **Site area** : 2240 m²

Objectives:

- women of war to rebuild their lives .
- Developing the economy and developing society .
- Reviving African heritage.

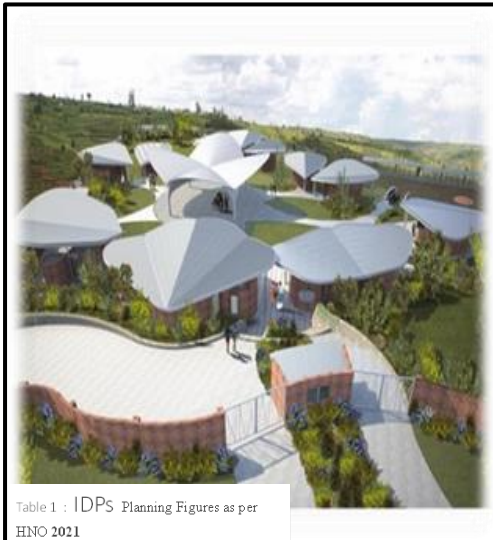

• Land Use

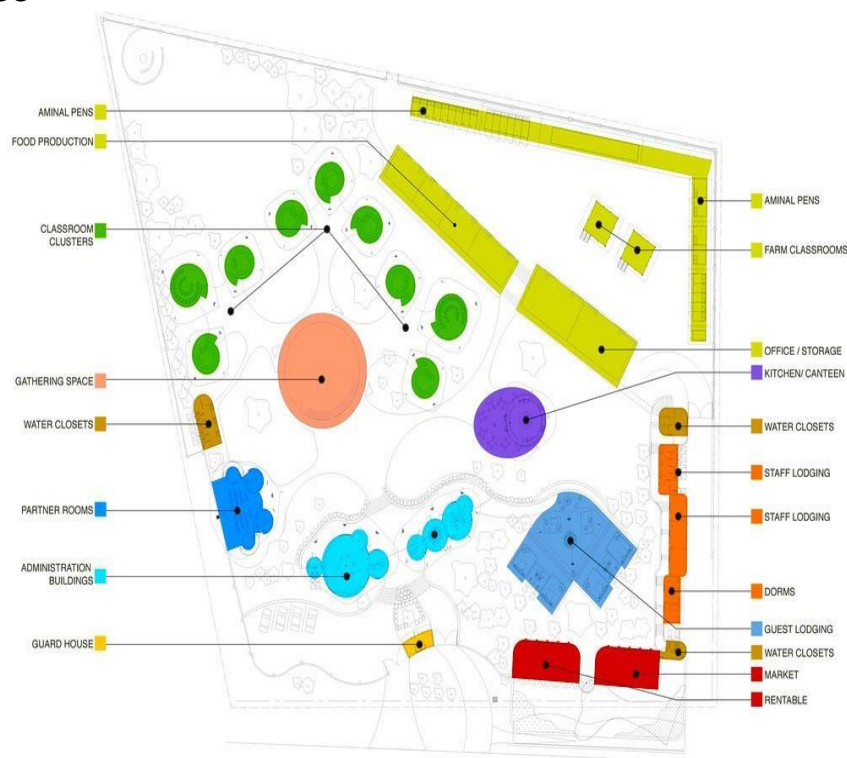

Table 1 : IDPs Planning Figures as per HNO 2021

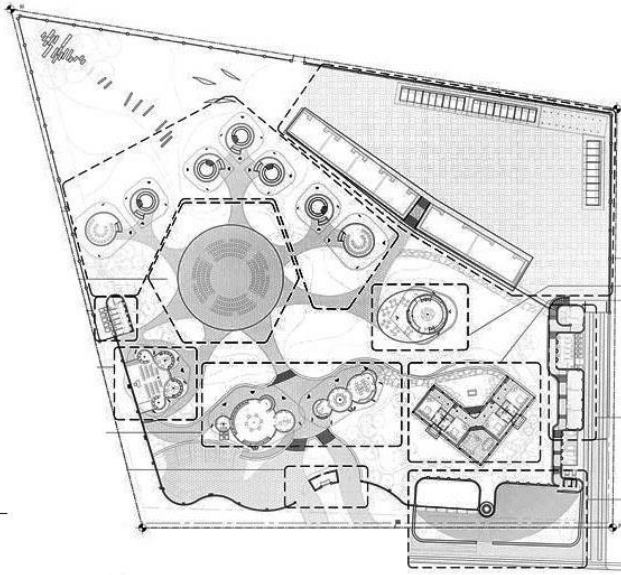

Table 1 : IDPS Planning Figures as per HNO 2021



Table 1 : IDPS Planning Figures as per HNO 2021

✚ Sustainability:-

- Natural lighting and ventilation
- They made a sustainable material from local bricks and used it in construction
- Use a biogas system instead of firewood

Pros	Cons
The building is compatible with the environment .	the spaces are small and not interconnected
The use of local materials in the building	the external spaces are large and zero space
It forms a comfort zone for users	The center needs different activities to increase the knowledge of women
the adoption of ventilation and natural lighting in a large way.	The proportion of the residential part is small

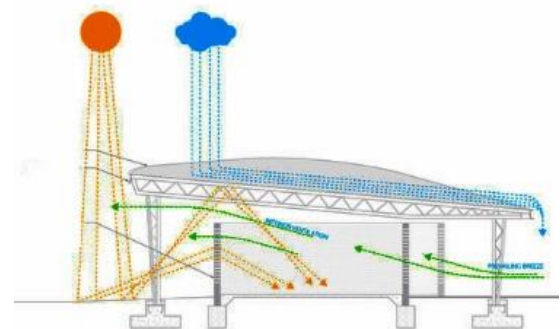

Fig 5: archdaily.com



Fig 6 : archdaily.com

Methodology :-

Visit the target area and refer to previous research and questionnaires , make a studies of the nature and behavior of the inhabitants of the area , make Research and collect general information about the project to know the needs, nature and size of the project after that search for similar models and compare projects to learn developments and solutions

Analyze past data , Access to functional and spatial relationships studied after that the beginning of the initial idea , Developing the initial idea by developing environmental and space solutions and materials , The stage of studies of the building in terms of services and reaching the necessary services, taking into account the means of sustainability , The stage of studying the details of everything related to the building , Final design and demonstration so that the project becomes real and ready for the implementation phase .

Providing a school in the complex with adult education opportunities to eradicate illiteracy , Reliance on local materials in construction and finishing , Adoption of the principle of sustainability in the design of the building, where the use of alternative energy, solar energy , Saving energy and air by using indoor patios to increase the humidity in the air Reviving the local heritage using the local character of Namli architecture in design



Fig1 : Part Section . GP The craft complex for the rehabilitation of displace woman in Darfur

Study result :-

Provide an appropriate building to achieve the desired goals so that this building is appropriate in terms of design, implementation and technology for the nature of the target scope . Creating opportunities that restore the spirit of life for people in post-war areas
Increasing opportunities for peace in the region, which could change the lives of more than 2 million people

How did the project help solve the problem?

- Employing refugees and local workers and training them to become skilled workers to achieve self-sufficiency to achieve one of the principles of sustainability in the region and encourage the local population to adopt the principle of sustainability or green architecture in Sudan and globally .
- Contributes to the craft industry.
- Benefit from sustainable, local raw materials.

Achieve the following goals

- Providing job opportunities for the displaced or refugees.
- Contributes to the craft industry.
- Benefit from sustainable, local raw materials.
- Educating displaced -refugees and rural women and local people and providing educational opportunities deprived of them by wars and conflicts.
- Encourage and promote peace.
- The center provides education & training opportunities.
- Directs users from consumers to productive people .
- Eradication of illiteracy in the region in an easy and concatenated way .
- Utilizing human and environmental resources to improve the situation of families and society .
- Self-sufficiency in the region and the country and opening the door for export in the future.

Displace Brief :

• study problem

In Africa in general, and in Sudan in particular, the refugee or displaced person in the post-war areas is exposed to the loss of the least basic of life, such as housing, education, health and the right to legitimate work. The refugee or displaced person resorts to searching for what is possible to make his family scattered and confused, and he has no choice but marginal work. Living on the margins in areas where there are no public services such as water, electricity and sanitation, so the person and the refugee child are exposed to greater risks of disease than the average person, with the difficulty of providing money for treatment

The problems faced by the displaced and refugees are endless. In this project, I addressed the women component, especially in light of the wars and conflicts that took place in Darfur, girls and children were taken out of schools and left their villages, heading towards the unknown now, in 2021, the displaced women are still seeking only the decent life they deserve The women inside the displacement camps expressed their desire

How did the project help solve the problem?

- Employing refugees and local workers and training them to become skilled workers to achieve self-sufficiency to achieve one of the principles of sustainability in the region and encourage the local population to adopt the principle of sustainability or green architecture in Sudan and globally
- Contributes to the craft industry
- Benefit from sustainable, local raw materials

TOTALE	2,432254
South Darfur	793,328
North Darfur	503,200
Central Darfur	446,390
West Darfur	336,529
East Darfur	135,024

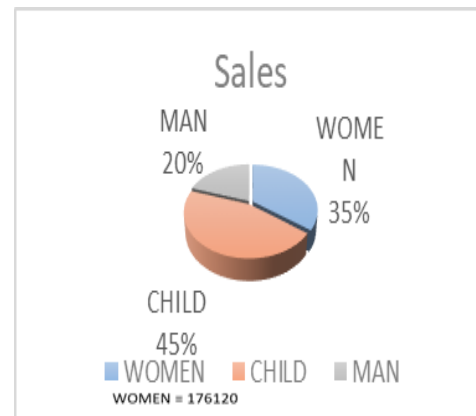

Fig3: GP The craft complex for the rehabilitation of displace woman in Darfur

The basis for choosing the site:-

- ❖ Near raw materials and workers .
- ❖ Close to residential areas.
- ❖ It arrives by main line or railway.
- ❖ The hill is good .
- ❖ Groundwater level is low.

The main domains of the site

- Rehabilitation activities .
- Social activities.
- cultural activities.
- administrative activities.
- Residential activities.
- entertainment Sports activities.
- Pastoral activities .
(psychological counseling - child care)



Project Components

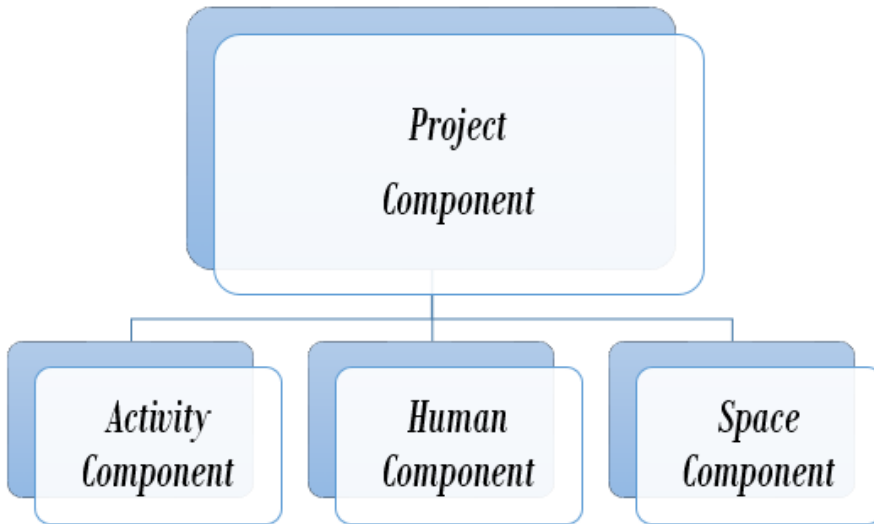

Functional plan :

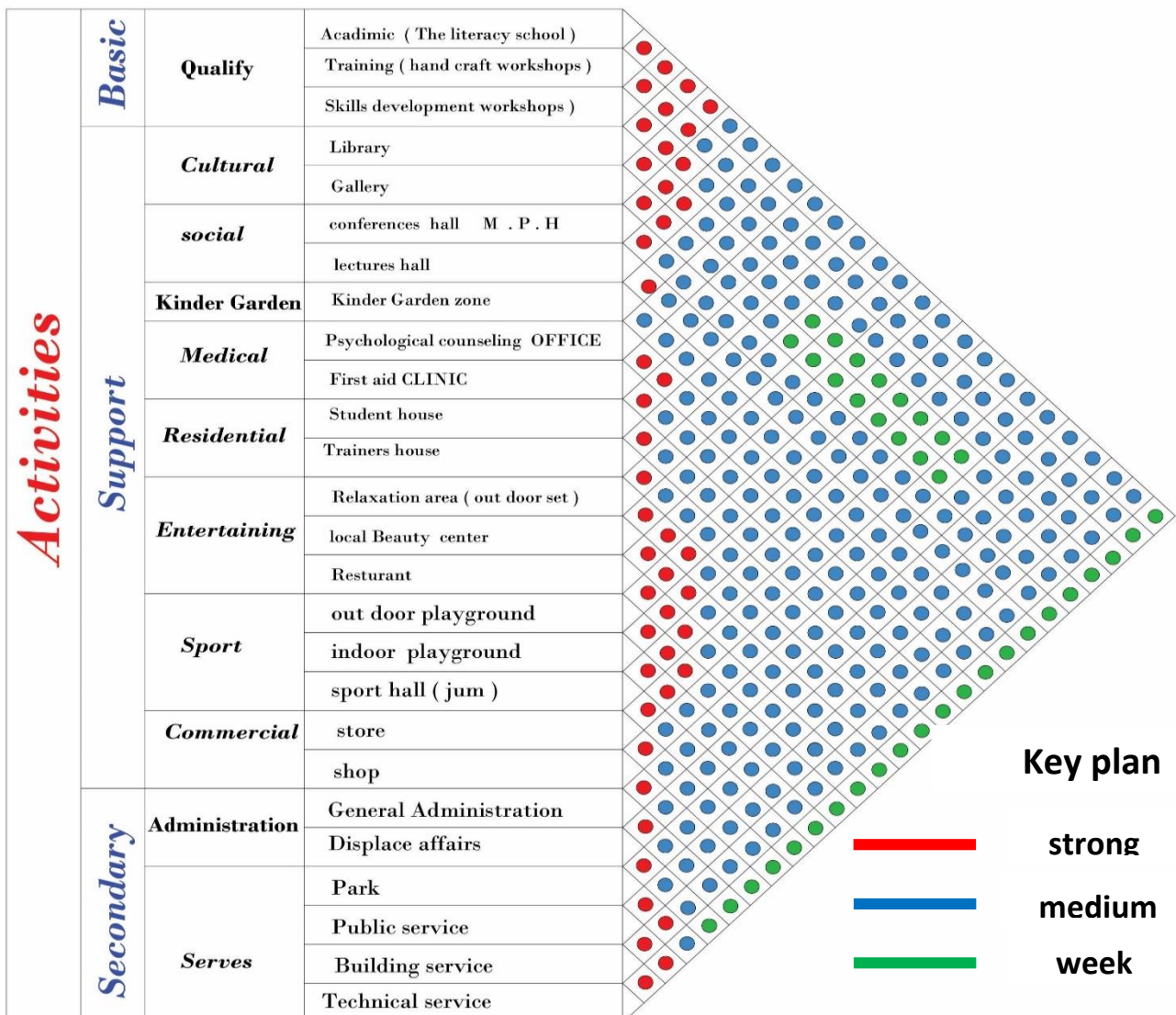

General Functional Plan :-

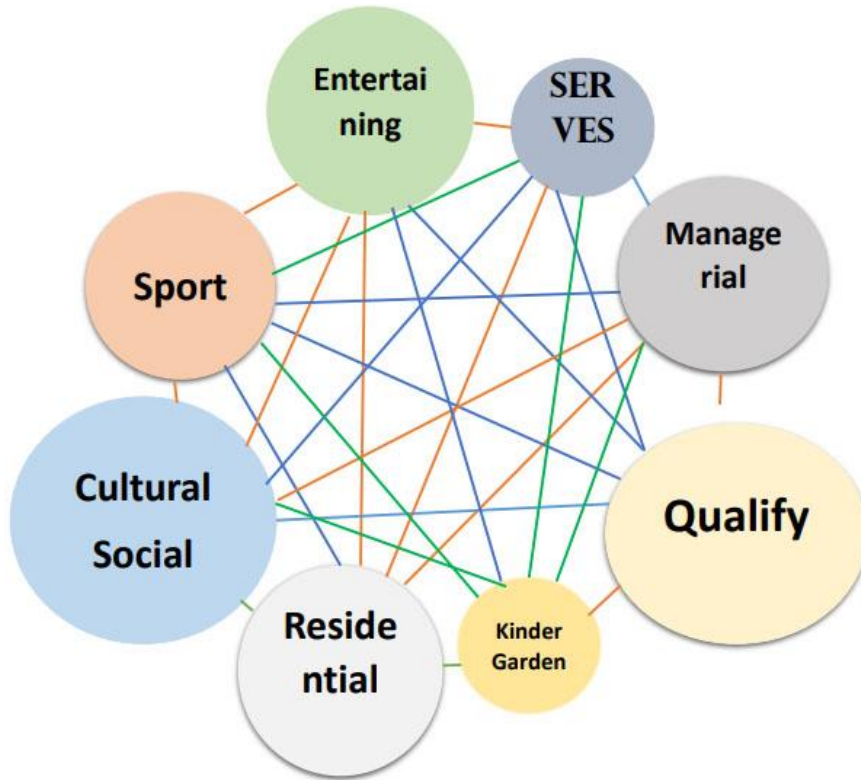

General Movement :-

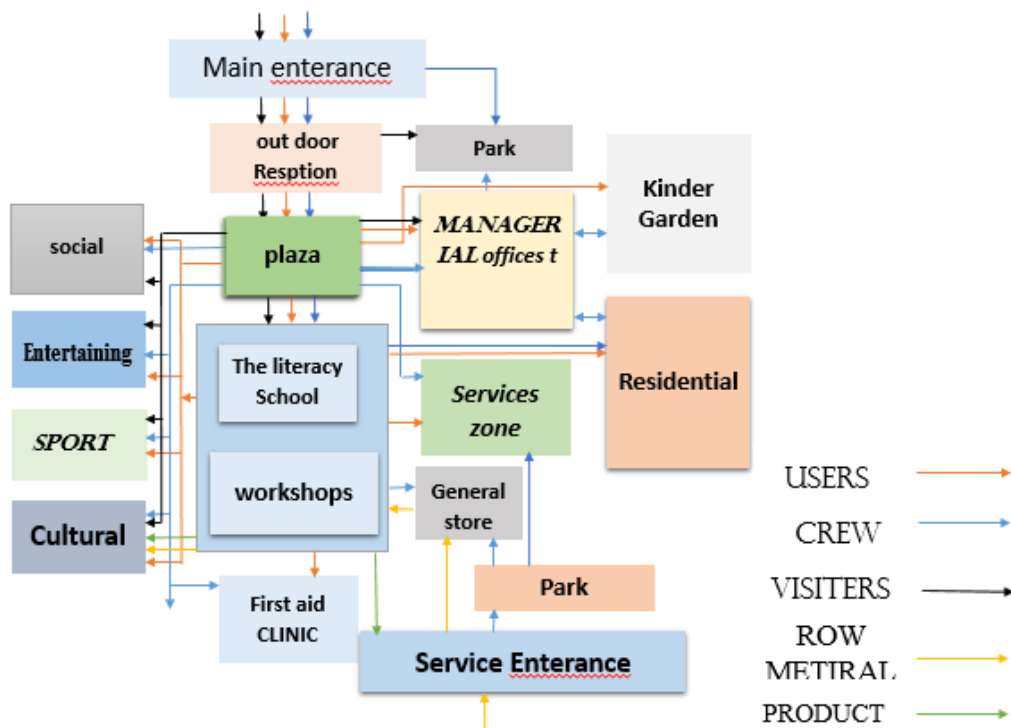

Zones	Zones spaces	By Percentage
Qualify	3046.5	14%
Cultural –	748.1	17%
Social	3675.8	14.7%
Entertaining	1705	9%
Sport	1578.6	13%
Psychological counseling	400	1.4%
Managerial	802.6	14.6%
Serves	4652	17%
residential	4650	17%
Kids Care	400	1.4%
Total	27,965.5 M2	
Building Area	225666.2	
Green Area	3159	
Movement Area	9.787	
Final Site Area	41.600 M2	

✚ Design philosophy :-

- **Design:**

The distribution of the sectors according to the function and the surrounding environment in terms of the function of the spaces the tree belt the northeastern part is exposed to dry monsoon winds, so I used tree windbreaks to tell the amount of dry wind that the building will be

- **The inner courtyard :-**

to reduce the amount of high temperatures and rely heavily on natural ventilation, to modify and employ the shape of the building block so as to ensure green spaces within each area .

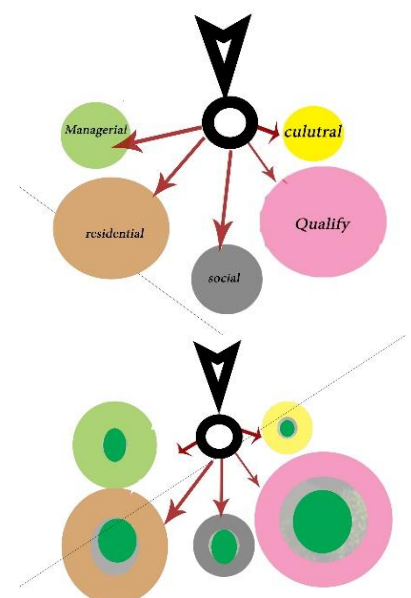

- **Orientation :-**

so that the largest side of the building is oriented north-south at an inclination of 18 degrees east-west

- **Wind direction:-**

There is a disturbance from the southeast direction of the building, so the spaces that need quietness are placed on the western side

- **Darfurian heritage and architectural character:-**

The Western heritage and the local character of building forms and used materials played a major role in designing and modifying the shape of the built building, as direct and shaped elements similar to the formation of the Bertal were used

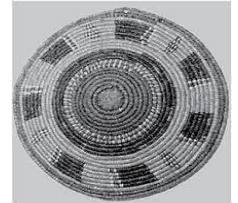
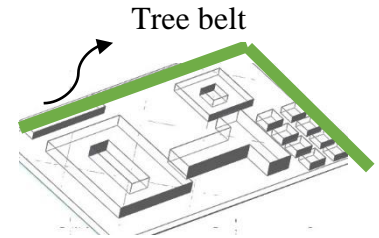

■ Heritage

■ Orientation

■ Wind direction

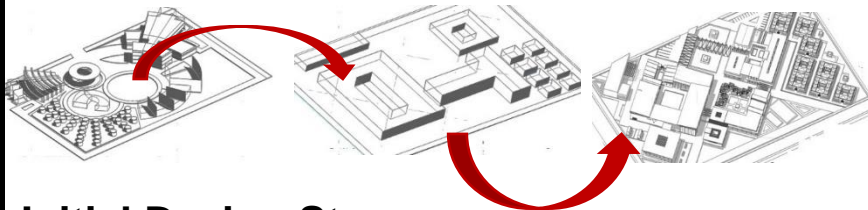

Initial Design Stage

The complex was divided into rooms according to the function, spaces and general environmental requirements, and it took the design of the Darfur circular Bertal by devising it as a design for the complex .

- **Problems With Circular Design:-**

- Wasted and insufficient space with the large site area
- The outside sessions are completely unemployed
- Connecting the blocks will give a huge building that is incompatible with the nature of life of the residents in the area
- Difficulty obtaining as much of a natural identity as possible

Main entrance

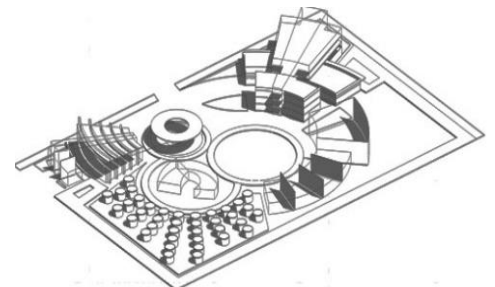
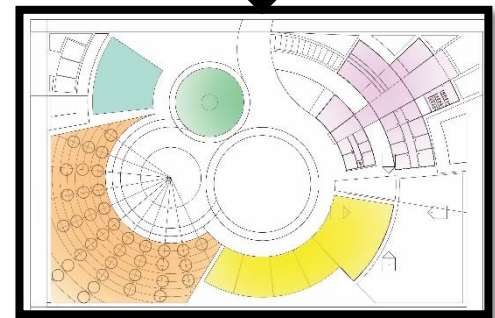

Advanced Design Stage :-

Unemployed skill block

Connect the blocks to each other

Closing the nickname with the continuous street to cut the visual penetration

Uniting the garage area

Distancing the nursery from the recreational and sportive selves



Final design:-

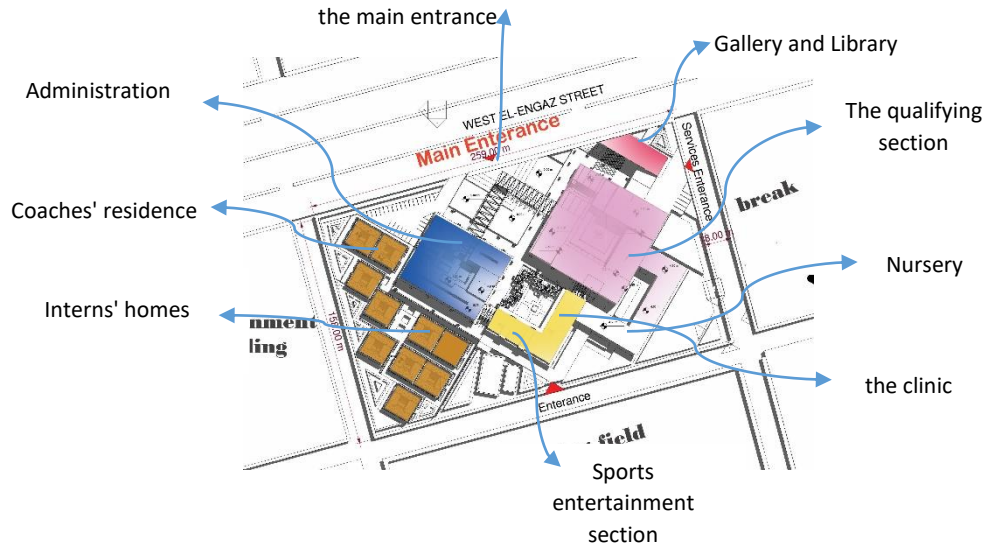

DEFINITION OF THE PROJECT:
THE CRAFT CENTER FOR THE REHABILITATION IS A SUSTAINABLE REHABILITATION, CULTURAL, SOCIAL, RESIDENTIAL DEVELOPMENT CENTER INCLUDES BASIC LEVELS OF EDUCATION (TO INCREASE LITERACY) AND TO INCREASE THEIR PRODUCTIVITY THROUGH FORMING TRAINING PROCESSES AND CONDUCTED CRAFT WORK AND SKILLS DEVELOPMENT PROVIDING JOB OPPORTUNITIES IN THE CRAFT FIELD SUCH AS (SEWING, MACHINE, TRADITIONAL PRODUCTS (ALBERTAL), TEXTILE, CARPENTRY, THE OR WORKS... ETC.) INSIDE THE CENTER AND FURTHER ACTS AS A COMMUNITY CENTER FOR THE NEIGHBORHOOD.

DESIGN PHILOSOPHY
*THE WESTERN HERITAGE AND THE LOCAL CHARACTER OF BUILDING FORMS
*USED MATERIALS PLAYED A MAJOR ROLE IN DECORATING AND MODIFYING THE SHAPE OF THE BUILDING, AS DIRECT AND SHAPED ELEMENTS SIMILAR TO THE FORMATION OF THE BERTAL WERE USED

LOCATION

THE SITE

EARTH

AFRICA

NORTH DARFUR

SUDAN

CONCEPT

THE INNER COURTYARD: TO ENSURE THE ABILITY OF HOME EMPLOYEES AND RELY EASILY ON NATURAL VENTILATION TO REDUCE THE ENERGY OF THE BUILDING BLOCK SO AS TO ENSURE GREEN SPACES WITHIN EACH AREA

DESIGN: THE DISTRIBUTION OF THE SECTORS ACCORDING TO THE FUNCTION AND THE SUBORDINATE ENVIRONMENT IN TERMS OF THE FACTOR OF THE SPACES THERE IS AN OBSTACLE FROM THE SOUTHWEST DIRECTION OF THE BUILDING, SO THE SPACE THAT KEEP QUOTIENTS ARE PLACED ON THE WESTERN SIDE.

ORIENTATION: SO THAT THE LARGEST SIDE OF THE BUILDING IS ORIENTED NORTH SOUTH AT AN INCLINATION OF 15 DEGREES EAST WEST

ZONING

1

2

3

PROJECT NAME: THE CRAFT COMPLEX FOR THE REHABILITATION OF DISPLACED WOMAN IN DARFUR

DECEMBER 2017

EL-ENGAZ WEST STREET

MAIN ENTRANCE

NEIGHBOR

NEIGHBOR

OPEN AREA

SOUTH ENTRANCE

SITE PLAN
SCALE 1:1000

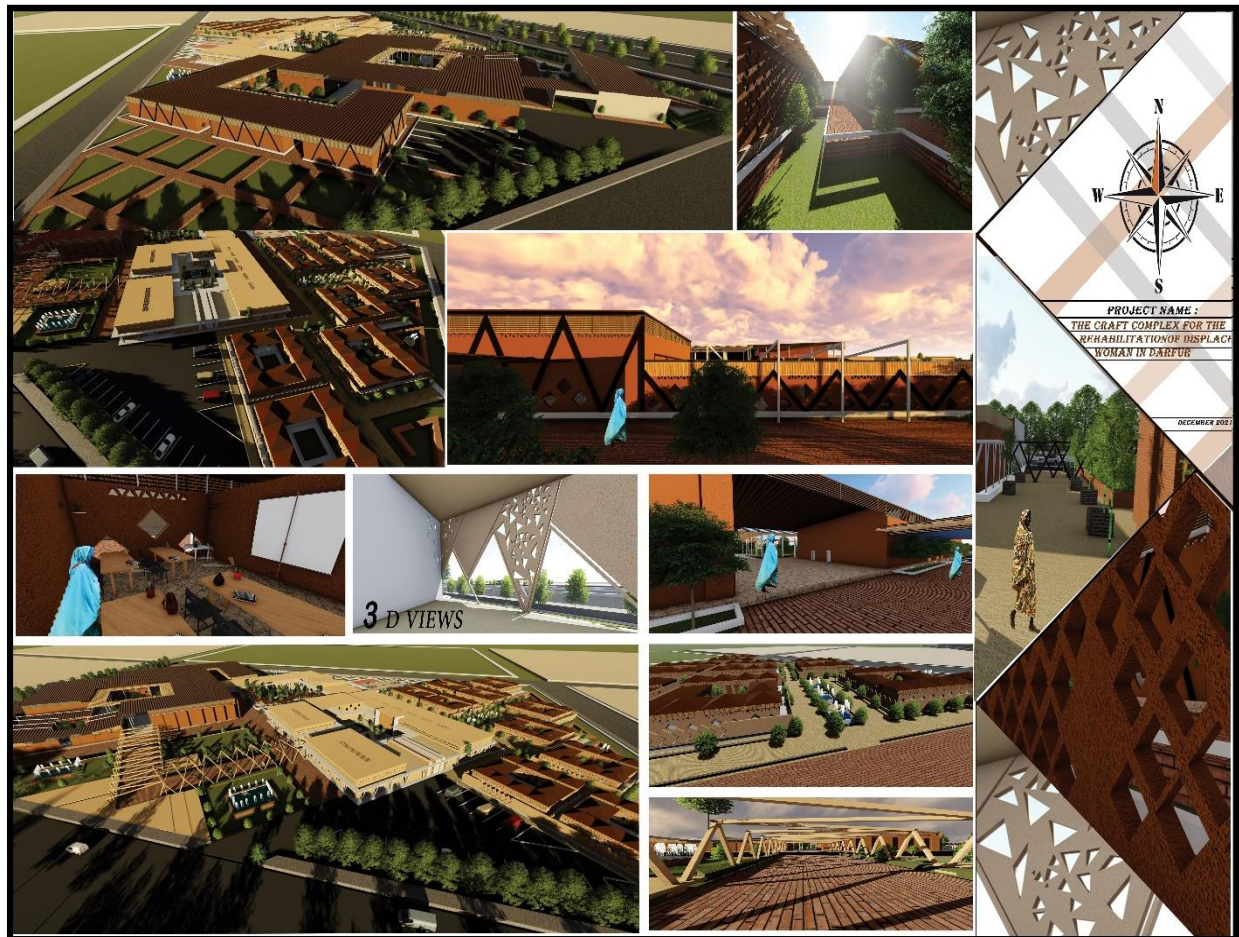
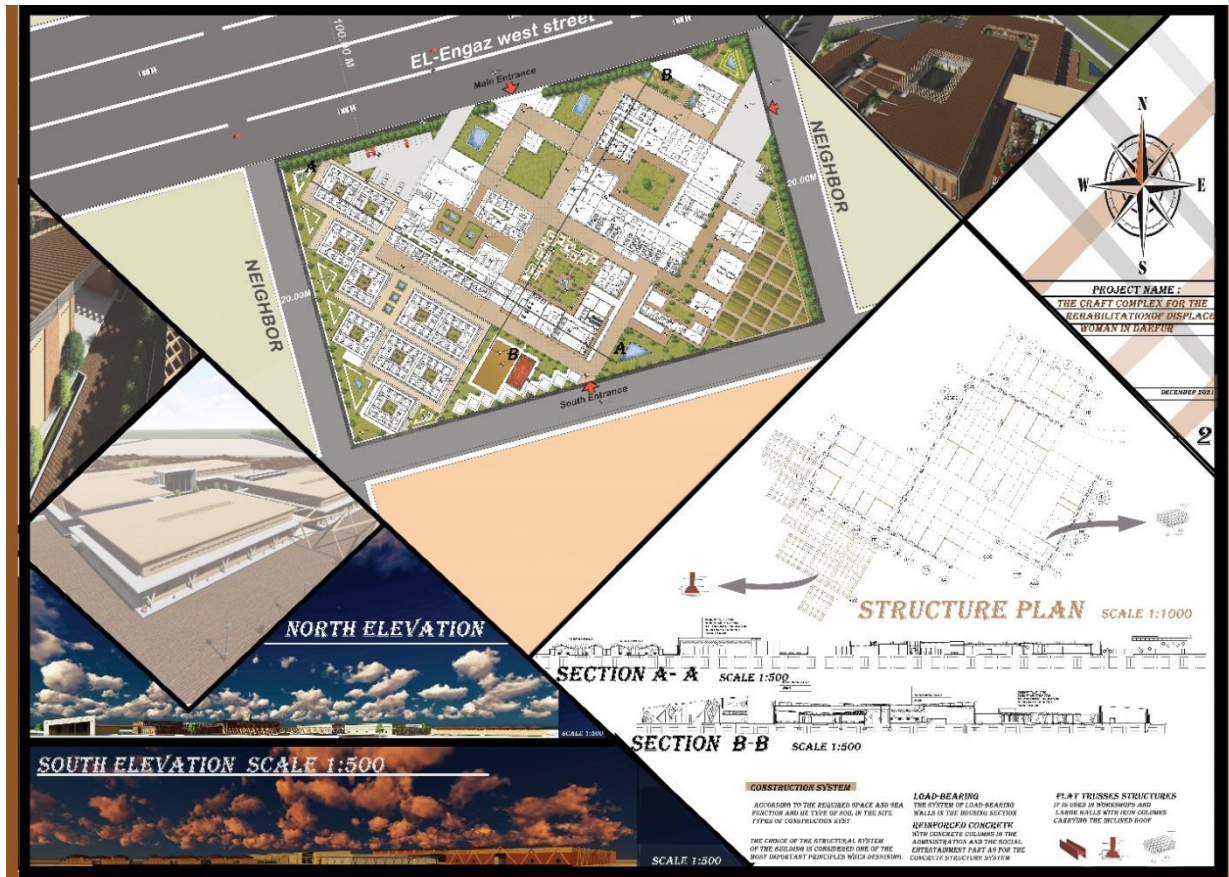

Conclusion:-

And at the end of this research, in which I made an effort that we did not spare for others, and in which I paid the utmost of our energy, so that this research would be comprehensive and fulfill all the themes and topics that we touched upon, as a guide and reference for every researcher interested in researching this subject (The craft Complex for the Rehabilitation of Displaced Women in Darfur), I have been keen to provide all the information from the official and official references, and all the ambiguous points in the research have been clarified

we have touched upon information and plans for the project of the craft complex for the rehabilitation of displaced women to rehabilitate the displaced person or refugee so that he is able to practice the normal life he deserves .

This is informations

of this purposeful project, and I hope that it will draw your attention to its bright future for peace, a kind of equality and human justice, and support for the cause of displacement and asylum around the world.

Recommendations:-

we wish this work takes a place in Sudan and is implemented in Sudan and Africa in all areas of conflict around the world so that Africa and the whole world can enjoy the peace and security it deserves . That refugees and displaced persons in the world obtain all their human and life rights to the fullest extent .

Together to encourage African youth to build Africa .

This project will change the lives of more than a million people only in Sudan, what if it is implemented in all of Africa .

References:-

- Time-Saver Standards for Architectural Design Data
 - Publisher : McGraw-Hill; 7th edition (November 1, 1997)
 - Author : Biography
- Construction of Buildings (Part Three) –
 - Farouq Abbas Haider
-
- The Craft Complex For The Rehabilitation Of Displace Woman In
 - Fardous abdalrasoul adam
 - Sudan University Of Science & Tecnology

Hits

- The ministry of construction planning
- North Darfur, El Fasher
- IDPS Planning Figures As Per Hno 2021

Websites

- https://www.archdaily.com/search/projects?ad_source=jv-header&ad_name=main-menu
<http://repository.sustech.edu/>
- https://cdnuploads.aa.com.tr/uploads/PhotoGallery/2016/04/19/thumbs_b2_804ca9bc5bef1740586ea10eaa1fbc43.jpg